

North American Amphibian Monitoring Program

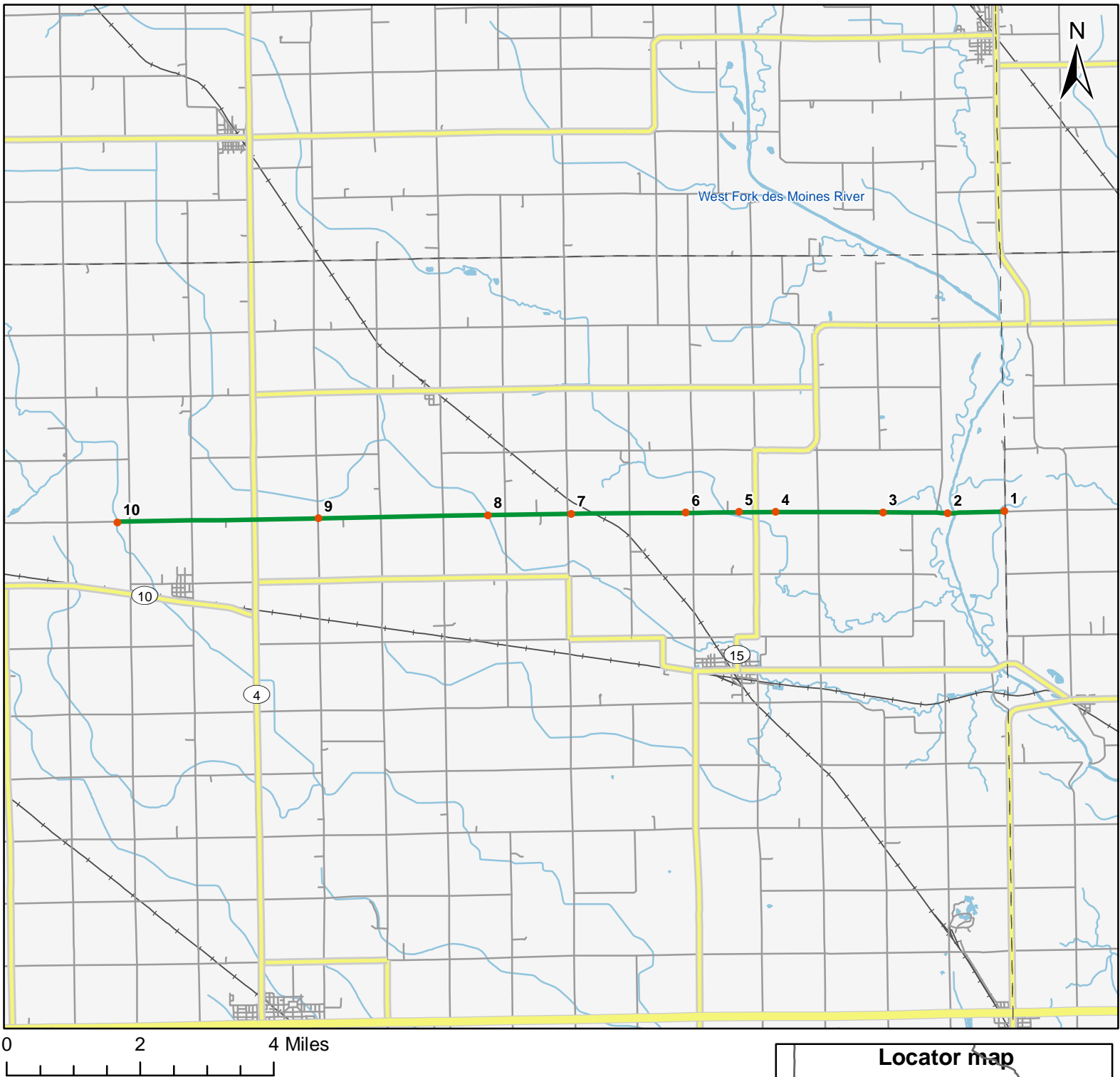

Route: 360409 Rolfe, IA



Legend

- Stop Locations
- Route Path



For more information, please visit the NAAMP website:
<http://www.pwrc.usgs.gov/naamp/>

Route: 360409 Rolfe, IA

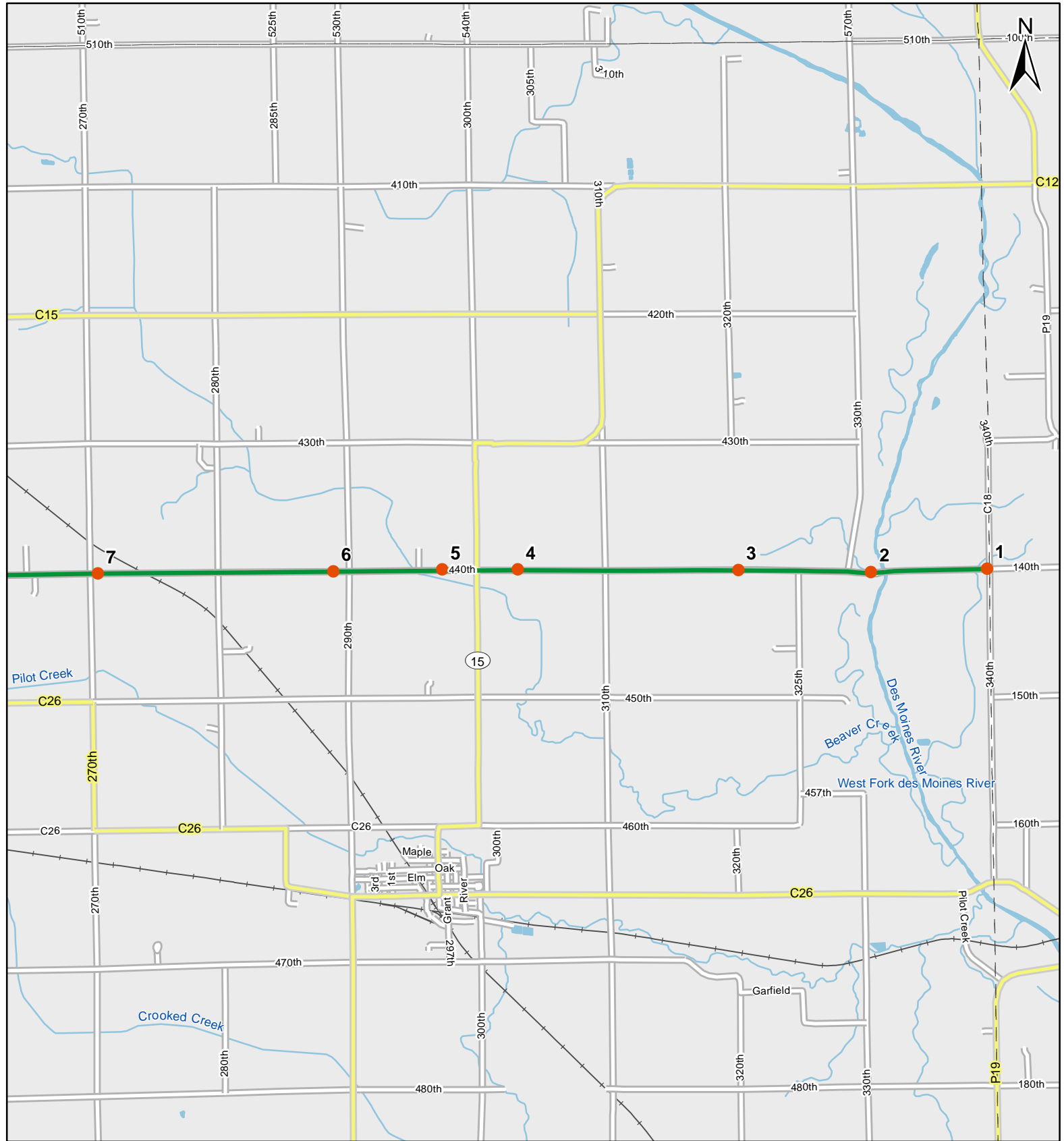

0 1 Miles

1:60,000

Legend

- Stop Locations
- Route Path

Route: 360409 Rolfe, IA

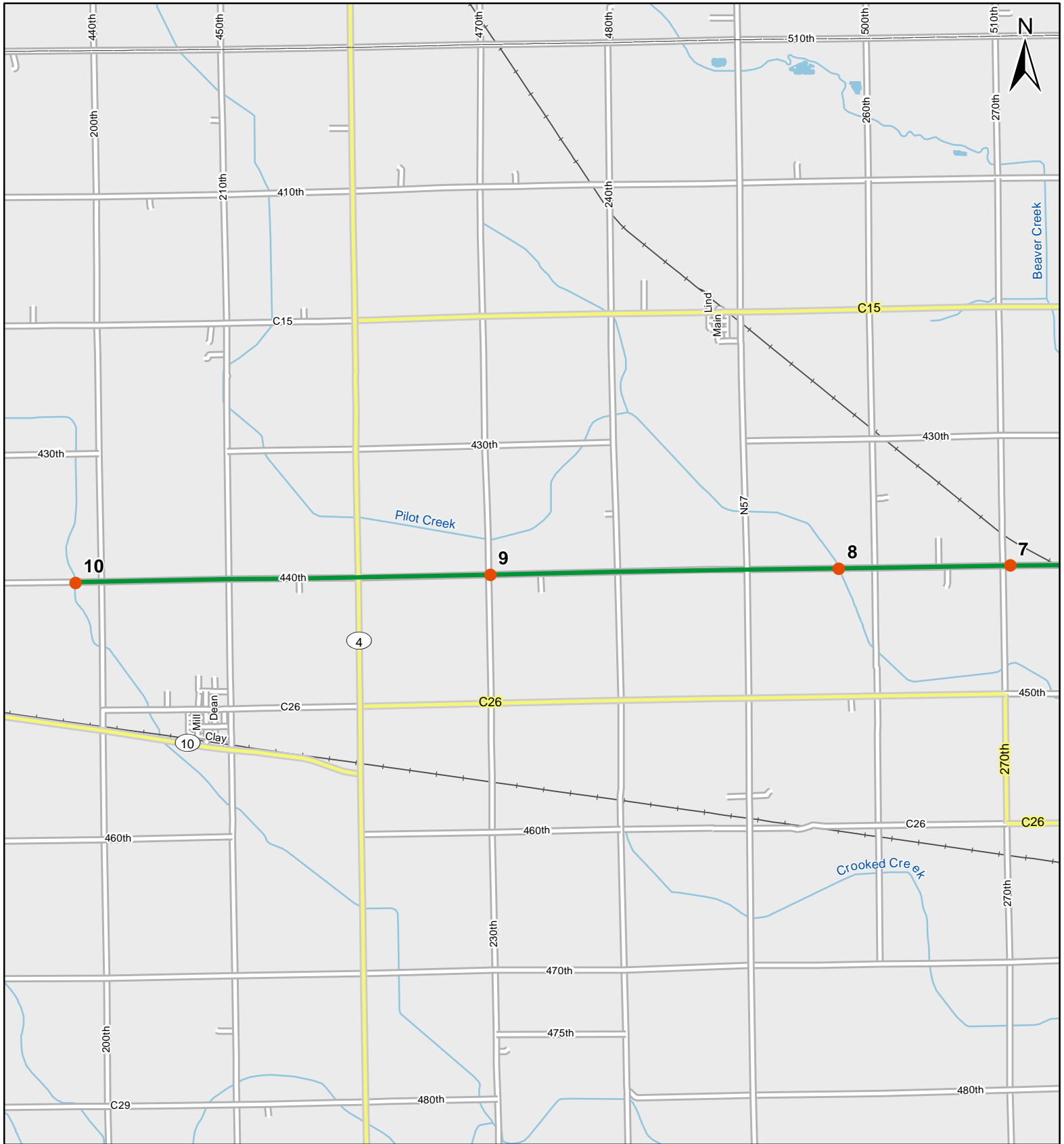

0 1 Miles

1:60,000

Legend

- Stop Locations
- Route Path



Frog and Toad Call Survey Route Description

Route ID **360409**

Established:

Site Number	Name	County	Latitude	Longitude	Directions
1	0	Pocahontas	42.8484993	-94.4431	Start facing west at corner of C18 and 440th. Deep ditch may periodically hold water and wood lot on low ground may also be seasonally wet.
2	0.8	Pocahontas	42.8483009	-94.4608994	Drive west on 440th. Stop at Ham's access on west side of bridge where there is standing water on the right side of the road.
3	1.9	Pocahontas	42.8488007	-94.4812012	Drive west on 440th ~0.5 miles past 325th is a grassed waterway on the left (south)side of road - does not come all the way to the road. There is a field pull off on the right.
4	3.6	Pocahontas	42.8493004	-94.5149994	Continue west on 440th and cross over 310th. Site is a samll grass and tree bordered stream running north to south under the road. Huge culverts. Cropfields on either side.
5	4.2	Pocahontas	42.8493996	-94.5264969	Continue west, cross over 15. ~0.2 miles further is a wet marshy meadow on the left. Clump of willows. Is before you get to the bridge.
6	5.1	Pocahontas	42.8493996	-94.5431976	Continue west on 440th and cross over 290th. ~0.1 miles, just past a house is a small clump of cattails in the deep roadside ditch on the left.
7	6.9	Pocahontas	42.8496017	-94.5792999	Continue west on 440th. Just before you get to the intersection with 270th there is a decent clump of cattails in the road ditch on right.



Frog and Toad Call Survey Route Description

8	8.2	Pocahontas	42.8494987	-94.6054993	Continue west on 440th. Just after crossing over 260th, stop at bridge over creek.
9	10.9	Pocahontas	42.8494987	-94.658699	Continue west on 440th. Stop at intersection with 230th. Creek is 150 yards to the north - can see the bridge.
10	14.1	Pocahontas	42.8492012	-94.7220993	Continue west on 440th. After crossing 200th stop at bridge over creek.